

prospetto fronte strada - COMPOSIZIONE FINALE

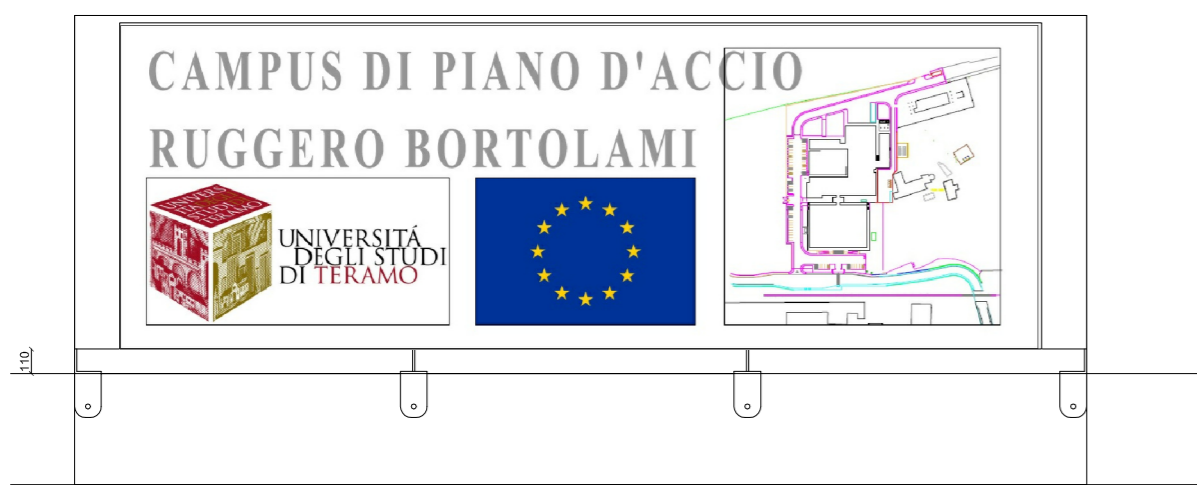

prospetto fronte strada

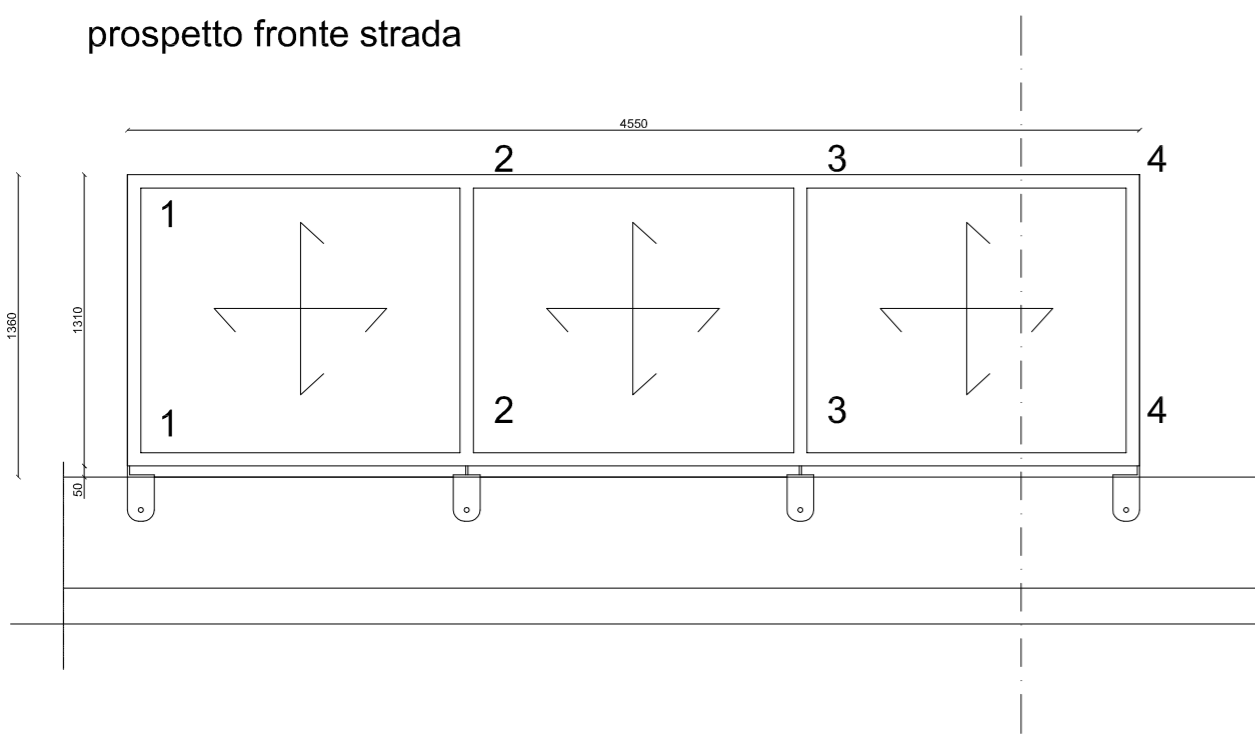

SEZIONE TIPO

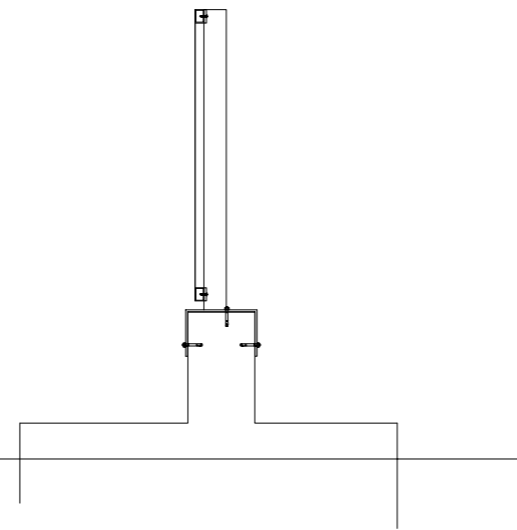

prospetto retro strada

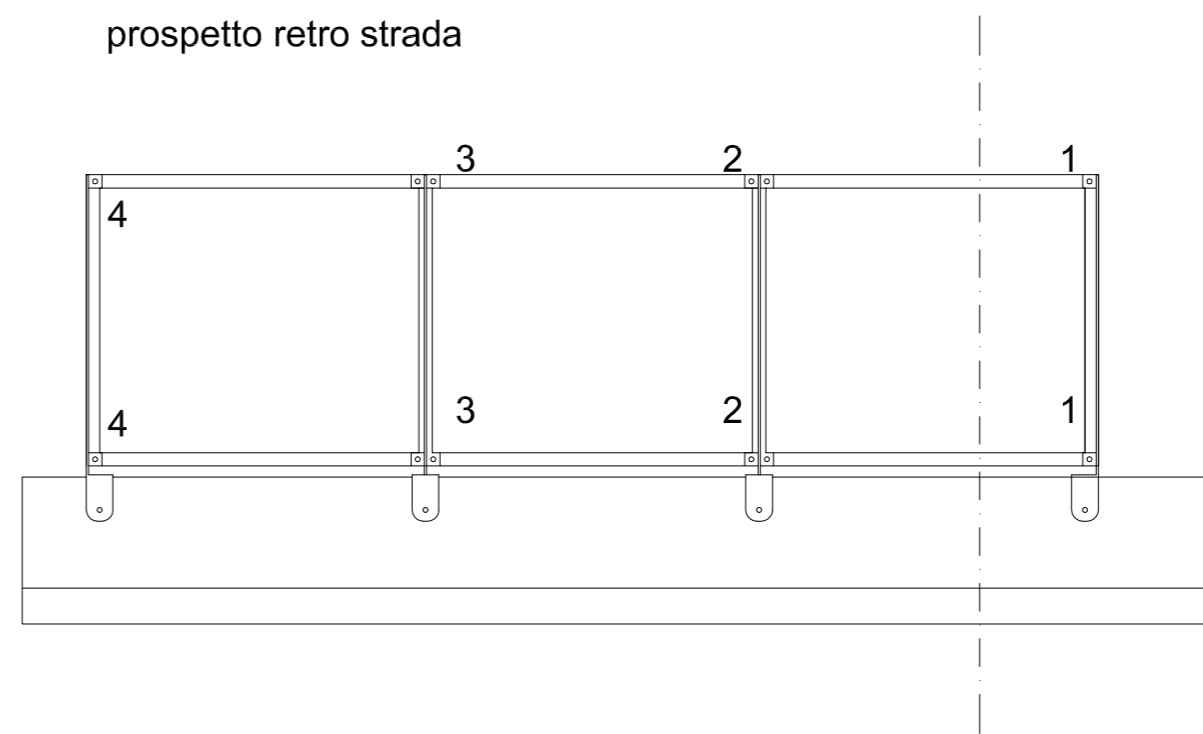

LAMIERA Zn -  $\frac{10}{10}$  - FISCHERATA CON TASSELLI IDONEI PER ESTERNO

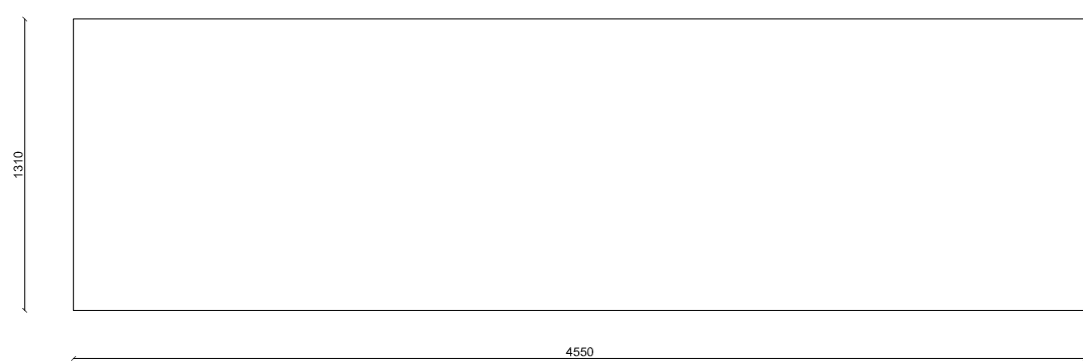

DRITTI LATERALI - FILO 1

LATO



FRONTE

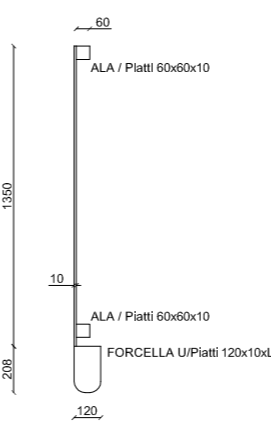

DRITTI CENTRALI - FILI 2,3

LATO



FRONTE

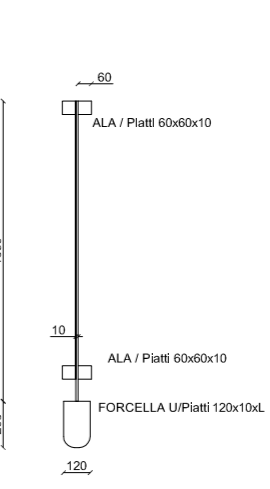

STRUTTURA TUBI  $\square$  60x40x3,2 - P lineare= 4,62 Kg/m

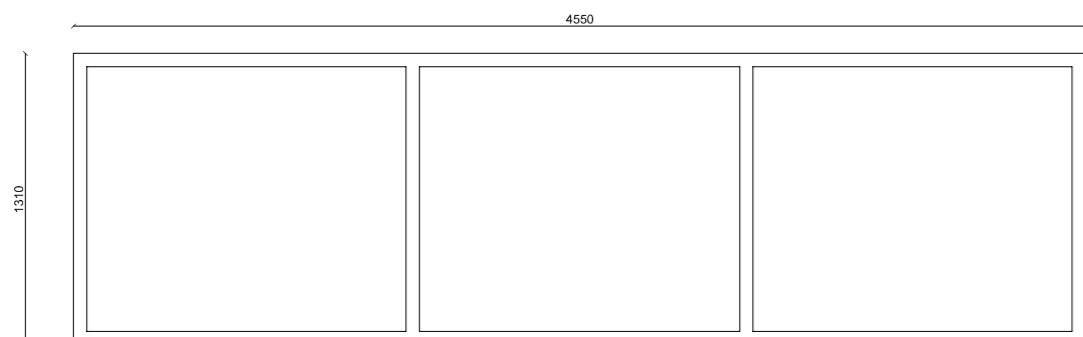

DRITTI LATERALI - FILO 4

LATO

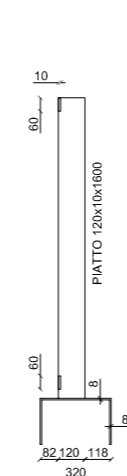

FRONTE

